

## The best way to Akashi-Kaikyo Bridge Exhibition Center by trains or highway buses

- Maiko Station in JR Kobe Line .....About 5 minutes' walk from the Stations
- Maiko-koen Station in Sanyo Electric Railway .....About 7 minutes' walk from the Stations
- Kosoku Maiko Bus-stop.....About 7 minutes on foot from the Bus-stop

※ Akashi-Kaikyo Bridge Exhibition Center is open at 9:15.

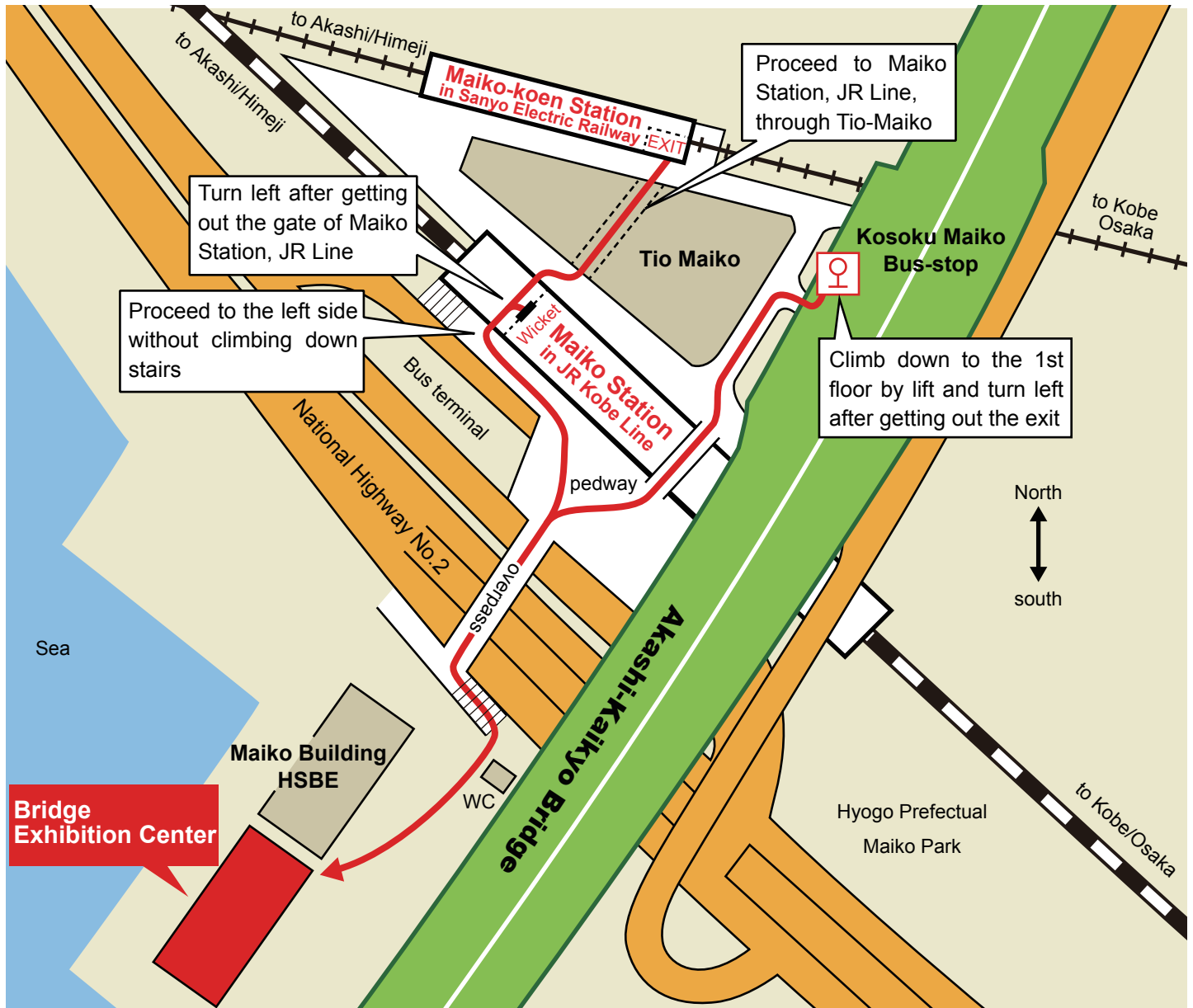

### ● For inquiry

Address	4-115 Higashi-Maiko-cho, Tarumi-ku, Kobe 655-0047 Secretary of Bridge World
TEL	+81-78-784-3396
FAX	+81-78-787-5110
Open	9:00 to 17:00, on February 1 to November 30
Regular holidays	Saturdays, Sundays and holidays until March 31 Mondays except for holidays on Mondays from April 1